

SUPPORT AND EXHIBITION PROSPECTUS

WCN
2017



XXIII World Congress of Neurology

September 16–21 2017,
Kyoto, Japan

www.wcn-neurology.com

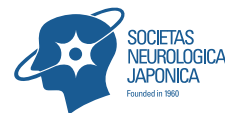

Defining the Future of Neurology

TABLE OF CONTENT

ABOUT THE WORLD FEDERATION OF NEUROLOGY (WFN)	3
OBJECTIVES OF WCN 2017	4
WCN CONGRESSES DELEGATE STATISTICS	5
INFORMATION ABOUT THE CONGRESS LOCATION AND VENUE	7
KICC – Kyoto International Congress Center	8
GENERAL INFORMATION AND CONTACTS	9
CME ACCREDITATION	10
SUPPORT LEVELS AND BENEFITS	11
Educational Support Opportunities	12
Promotional Support Opportunities	13
EXHIBITION OPPORTUNITIES	15
EXHIBITION FLOOR PLAN	16
GENERAL INFORMATION AND CONDITIONS OF EXHIBITION	17
BOOKING FORM AND CONTRACT	18-20
TERMS AND CONDITIONS	21

ABOUT THE WORLD FEDERATION OF NEUROLOGY (WFN)



The World Federation of Neurology is the international body representing the specialty of neurology in more than 100 countries/regions of the globe.

The mission of the WFN, as a UK registered charity, is **to foster quality neurology and brain health worldwide**, a goal we seek to achieve by promoting global neurological education and training, with the emphasis placed firmly on under-resourced parts of the world.

The WFN holds biennial world congresses, which rotate throughout the regions (Africa, Americas, Asia, Europe) of the world. The congress consists of scientific sessions, teaching courses as well as structural and business meetings. The next congress following Chile (2015) will be in Kyoto, Japan 2017.

The WFN is eager to promote neurology worldwide, and to improve prevention and diagnosis management for patients.

It shall be the purpose of the World Federation of Neurology to improve human health worldwide by promoting prevention and the care of persons with disorders of the entire nervous system by:

- ▶ Fostering the best standards of neurological practice
- ▶ Educating, in collaboration with neuroscience and other international public and private organizations
- ▶ Facilitating research through its Research Groups and other means

The WFN has a website (www.wfneurology.org), social media ([Facebook](#), [Twitter](#)) an electronic magazine [WN](#) (available on the website), and two scientific journals; the [Journal of the Neurological Sciences](#) and [eNeurological Sci.](#)

OBJECTIVES OF WCN 2017

WCN 2017 will bring together leading scientists, public health experts, policy-makers to translate recent momentous scientific advances into action that will address means to end the epidemic, within the current context of significant global economic challenges.

The WCN 2017 will have a positive impact on the topics of the congress response globally with the following objectives:

- ▶ To bring together the worlds scientific experts to catalyze and advance scientific knowledge about Neurology, present the most recent research findings, and promote and enhance scientific collaborations around the world
- ▶ To bring together community leaders, scientists, and policy leaders to promote and enhance programmatic collaborations to more effectively address regional, national and local responses to neurology around the world and overcome barriers that limit access to prevention, care and services
- ▶ To engage key, new and non-traditional stakeholders throughout the world in the development of and participation throughout the Congress program

Why should you Participate?

- ▶ Demonstrate your company's leadership in the field of Neurology
- ▶ Reach key thought leaders academic and industry researchers and clinicians
- ▶ Raise your company's visibility in the field of Neurology
- ▶ Exhibit and distribute your marketing and promotional materials
- ▶ Convene a corporate symposium
- ▶ Relationships between the WFN and its industrial partners is to be based on equal partnership.
- ▶ Both the WFN and partners will work together on policy development and practical initiatives, in the interests of all the member organizations
- ▶ Successful partnerships are those where both partners gain by making the effort to understand the internal culture and external pressures of the other

GENERAL INFORMATION AND CONTACTS

Dates:

September 16-21, 2017

Official Language:

English

Venue:

KICC – Kyoto International Congress Center

<http://www.icckyo.or.jp/en/>

Number of expected delegates:

Over 5,000 delegates

Congress Organizer:

Kenes International

Rue François-Versonnex 7

CH-1207 Geneva, Switzerland

Tel: +41 22 908 0488 Ext. 541

Fax: +41 22 906 9140

Sponsorship & Exhibition Sales:

Judit Gondor

Tel: +41 22 908 0488 Ext. 531

Fax: +41 22 906 9140

E-mail: jgondor@kenes.com



WCN CONGRESSES DELEGATE STATISTICS

WCN 2011 in Marrakesh, 3,217 participants from 125 countries

WCN 2013 in Vienna, 6,400 participants from 135 countries

WCN 2015 in Chile, 3479 participants from 109 countries

Participants by Age

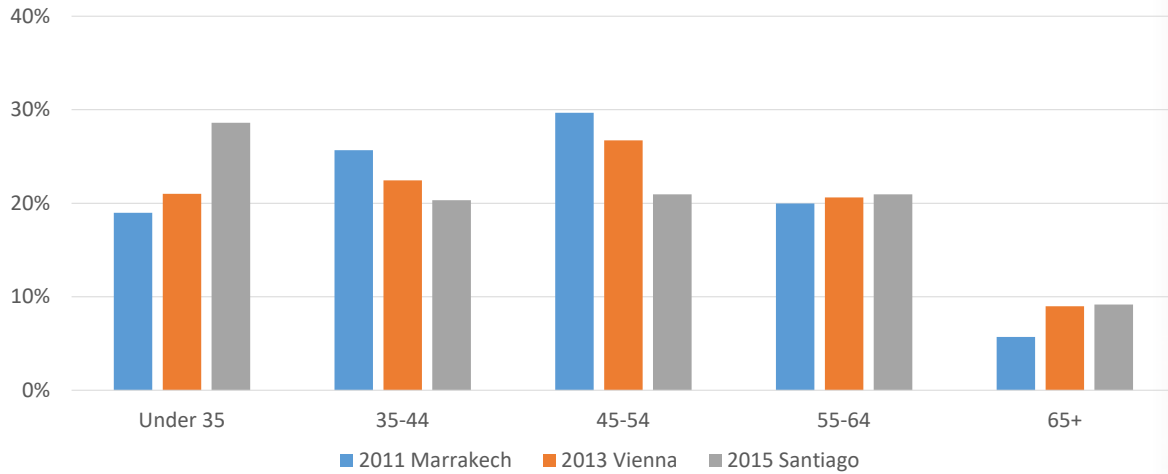

Professional Role

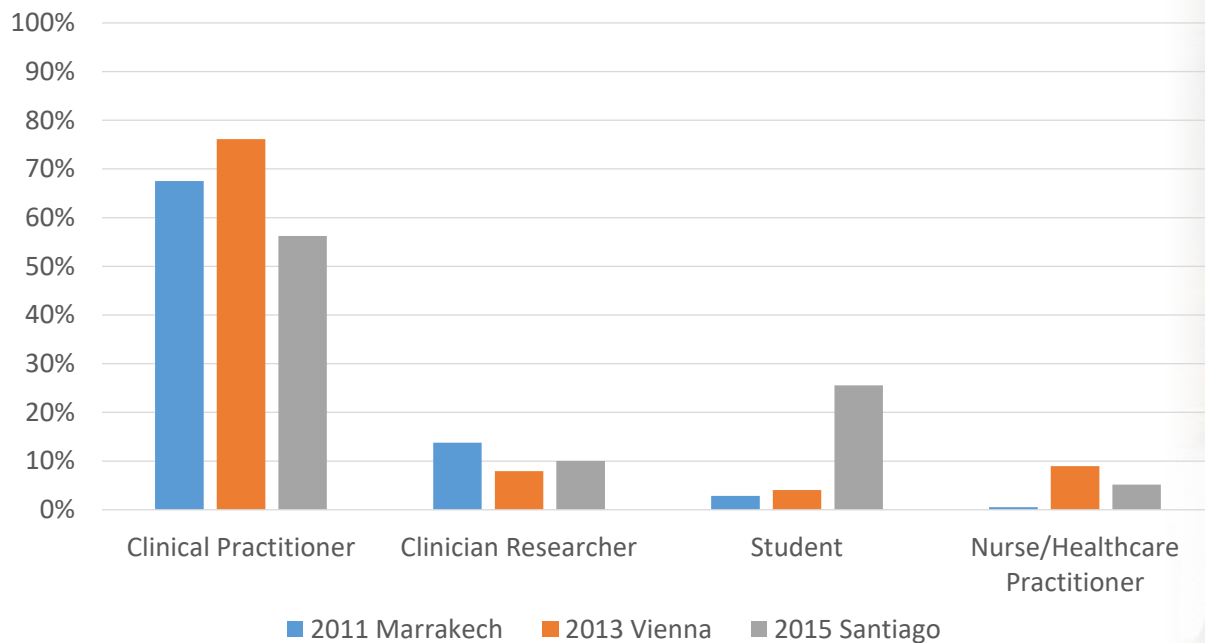

Registration Breakdown

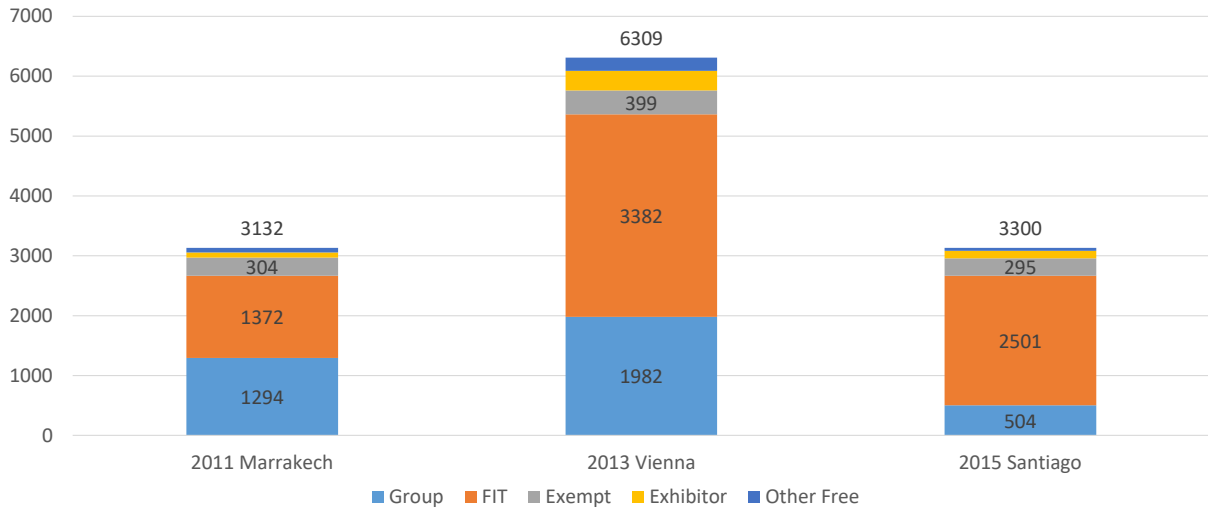

Registrants' Specialties

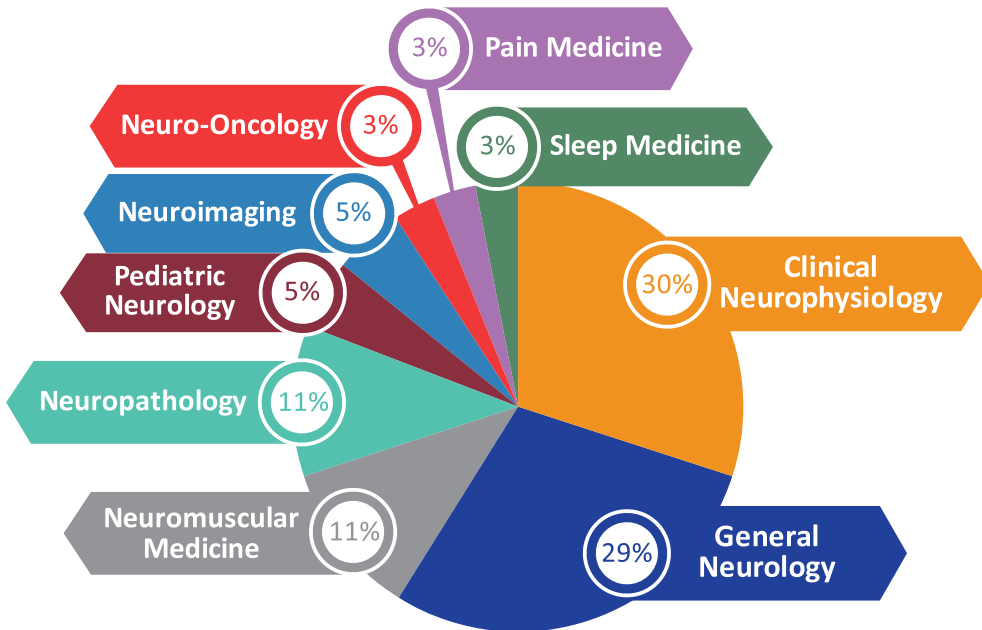

Registrants' Workplace

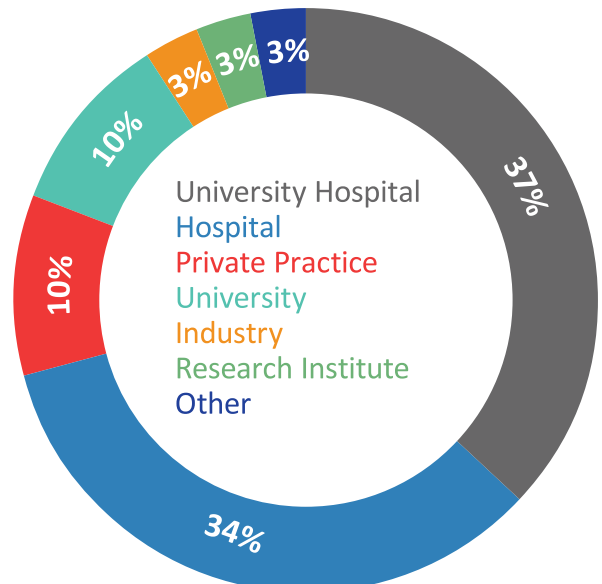

INFORMATION ABOUT THE CONGRESS LOCATION AND VENUE

Kyoto, Japan has a population of 1.5 million. There are three airports near Kyoto. The Osaka International Airport is 50 minutes away by driving. The Kansai International Airport is 90 minutes away by a direct train. The Central Japan International Airport is less than 90 minutes by airport express.

The climate in Kyoto is humid subtropical, summer is hot and humid while winter is cold with occasional snow.

Visitors must obtain a visa. There are currently 67 countries / territories that are exempt from having to obtain a visa. Visa exempt countries include: European Union, Andorra, Australia, Argentina, Bahamas, Barbados, Brunei, Canada, Chile, Costa Rica, Dominican Republic, El Salvador, Guatemala, Honduras, Hong Kong, Indonesia, Israel, Lesotho, Macau, Macedonia, Malaysia, Mauritius, Mexico, Monaco, New Zealand, San Marino, Serbia, Singapore, South Korea, Suriname, Taiwan, Thailand, Tunisia, Turkey, United States, Uruguay.



KICC – Kyoto International Congress Center

KICC Kyoto International Conference Center has staged over 16,000 conferences since it opened. KICC Kyoto International Conference Center has not only played a key role in the history of international conferences in Japan but is a flagship platform for large-scale conventions in Asia as well.

KICC Kyoto International Conference Center covers a vast site of 156,000m² that features Main Building, Annex Hall, Event Room And a Japanese garden as well as car parking for 450 vehicles. Together with the adjoining hotel, the site serves as a state-of-the-art complex devoted exclusively to conferences.

KICC Kyoto International Conference Center boasts more than 70 conference rooms including 9 halls with simultaneous interpretation equipment. The Main Building, Annex Room And Event Room Are connected by indoor passageways and linked by a digital network system comprising more than 600 fiber-optic cables. This network makes live video relay easy thereby enabling large-scale conferences of more than 7,000 people.

Highly experienced staff apply expertise accumulated since the conference center first opened, to provide total support for everything from conference planning and preparation, to execution. In addition to an in-house catering services company, Kyoto International Conference Center has more than 20 affiliated companies with specialists in every field. We can therefore provide a wide range of services and support, to match the scale and nature of any event.



Address: Takaragaike, Sakyo-ku, Kyoto 606-0001 Japan | <http://www.icckyo.or.jp/en/>

CME ACCREDITATION

Commitment to the Highest Standards in CME/CPD

Kenes is committed to being a valuable and knowledgeable partner in the design and delivery of educationally strong, independent, transparent, and effective CME/CPD programs. Kenes is a proud member of the Good CME Practice Group (gCMEp), a member organization contributing to improving health outcomes by:



- ▶ Championing best practice in CME
- ▶ Maintaining and improving standards
- ▶ Mentoring and educating
- ▶ Working in collaboration with critical stakeholders

Membership in the Good CME Practice Group illustrates the Kenes commitment to high standards and knowledgeable partnership with its clients in the design and delivery of educationally strong, independent, transparent, effective and financially viable medical events. For more information, visit: www.gcmep.eu

International CME Accreditation

1. An application for CME Credit will be made once the scientific program is finalized. Complete details will be available on the congress website.
2. An application will be made to the European Accreditation Council for Continuing Medical Education (EACCME) for CME accreditation of this event. The EACCME is an institution of the European Union of Medical Specialists (UEMS): www.uems.net

Satellite Symposia

Satellite Symposia are offered to industry as non-CME commercial/promotional sessions. As such, companies are free to choose their topics, invite speakers, and control content. However, topic and program are subject to approval by the scientific committee and all such sessions will be indicated in the program as: Satellite Symposium organized by: Company Name (not included in the main event CME/CPD credit offering)

PRELIMINARY PROGRAM

Teaching Course	Scientific Session: M (Main Topics)	Free Papers	Plenary Lecture	Regional Symposium Session	Scientific Session: T (Topics)	Sponsored Symposium	Tournament of the Minds	Breaks
-----------------	-------------------------------------	-------------	-----------------	----------------------------	--------------------------------	---------------------	-------------------------	--------

SATURDAY, SEPTEMBER 16, 2017

	Main Hall - Plenary	Annex Hall 1	Room A	Annex Hall 2	Room D	Room E	Room B-1	Room B-2	Room C-1	Room C-2	Room G	Room F	Room H
	COFFEE BREAK OUTSIDE SESSION HALLS												
14:30 - 18:00			Teaching Course	Teaching Course	Teaching Course	Teaching Course	Teaching Course	Teaching Course	Teaching Course	Teaching Course			

SUNDAY, SEPTEMBER 17, 2017

	Main Hall - Plenary	Annex Hall 1	Room A	Annex Hall 2	Room D	Room E	Room B-1	Room B-2	Room C-1
07:00 - 08:00						Morning Teaching Course			
8:00-9:15	PLENARY LECTURE (Nobel lecture) 8:00-8:45								
	PLENARY LECTURE 8:45-9:15								
9:15-10:45	M1a: Epilepsy	M4a: MS and Other Inflammatory Diseases	T1a: Neurorehabilitation Including Brain Machine Interface (BMI)	FREE PAPERS	T2a: Neurogenetics	Teaching Course	WFN COUNCIL OF DELEGATES MEETING	Teaching Course	FREE PAPERS
10:45-11:15	COFFEE BREAK, POSTER AND E-POSTER VIEWING AND EXHIBITION VISIT								
11:15-12:45	M1b: Epilepsy	M4b: MS and Other Inflammatory Diseases	T1b: Neurorehabilitation Including Brain Machine Interface (BMI)	T14a: Neurology in Migrants	T2b: Neurogenetics	Teaching Course	WFN COUNCIL OF DELEGATES (CONT'D)	Teaching Course	FREE PAPERS
12:45-14:45	LUNCH BREAK, POSTER AND E-POSTER VIEWING AND EXHIBITION VISIT	INTERNATIONAL PHARMA SPONSORED SYMPOSIUM INDUSTRY SESSION Not included in main event CME/CPD credit	INTERNATIONAL PHARMA SPONSORED SYMPOSIUM INDUSTRY SESSION Not included in main event CME/CPD credit	JAPANESE PHARMA SPONSORED SYMPOSIUM INDUSTRY SESSION Not included in main event CME/CPD credit (13:00-14:30)	JAPANESE PHARMA SPONSORED SYMPOSIUM INDUSTRY SESSION Not included in main event CME/CPD credit	JAPANESE PHARMA SPONSORED SYMPOSIUM INDUSTRY SESSION Not included in main event CME/CPD credit	JAPANESE PHARMA SPONSORED SYMPOSIUM INDUSTRY SESSION Not included in main event CME/CPD credit	JAPANESE PHARMA SPONSORED SYMPOSIUM INDUSTRY SESSION Not included in main event CME/CPD credit	LUNCH BREAK, POSTER AND E-POSTER VIEWING AND EXHIBITION VISIT
13:45-14:45					JAPANESE PHARMA SPONSORED SYMPOSIUM INDUSTRY SESSION Not included in main event CME/CPD credit	JAPANESE PHARMA SPONSORED SYMPOSIUM INDUSTRY SESSION Not included in main event CME/CPD credit	JAPANESE PHARMA SPONSORED SYMPOSIUM INDUSTRY SESSION Not included in main event CME/CPD credit	JAPANESE PHARMA SPONSORED SYMPOSIUM INDUSTRY SESSION Not included in main event CME/CPD credit	
14:45-16:15	M1c: Epilepsy	M4c: MS and Other Inflammatory Diseases	Teaching Course	REGIONAL SYMPOSIUM 1	FREE PAPERS	Teaching Course	Teaching Course	FREE PAPERS	FREE PAPERS
16:15-16:45	COFFEE BREAK, POSTER AND E-POSTER VIEWING AND EXHIBITION VISIT								
16:45-18:15	M1d: Epilepsy	M4d: MS and Other Inflammatory Diseases	Teaching Course	T15a: Traumatic Brain Injury	REGIONAL SYMPOSIUM 2	Teaching Course	Teaching Course	FREE PAPERS	FREE PAPERS
18:15-18:25	SHORT BREAK								
18:25-19:30	OPENING CEREMONY								
	WELCOME RECEPTION IN THE EXHIBITION AREA								

MONDAY, SEPTEMBER 18, 2017

	Main Hall - Plenary	Annex Hall 1	Room A	Annex Hall 2	Room D	Room E	Room B-1	Room B-2	Room C-1	Room C-2	Room G	Room F	Room H
07:00 - 08:00						Morning Teaching Course							
08:00 - 09:00	PLENARY LECTURE 8:00-8:30												
	PLENARY: VICTOR & CLARA SORIANO AWARD LECTURE 8:30-9:00												
09:00 - 10:45	WFN MEDALS PRESENTATION AND PRESIDENTIAL SYMPOSIUM												
	The neural systems of space, including grid cells Moser												
10:45 - 11:15	COFFEE BREAK, POSTER AND E-POSTER VIEWING AND EXHIBITION VISIT												
11:15 - 12:45	T11a: Disorders of the Autonomic Nervous System	M6a: Neuroimaging, Molecular Functional Imaging	T3a: Palliative Care	T16a: Environmental and Nutritional Disorders	FREE PAPERS	REGIONAL SYMPOSIUM 3	FREE PAPERS	FREE PAPERS					
12:45 - 14:45	LUNCH BREAK, POSTER AND E-POSTER VIEWING AND EXHIBITION VISIT	13:10-14:40 INTERNATIONAL PHARMA SPONSORED SYMPOSIUM INDUSTRY SESSION Not included in main event CME/CPD credit	13:10-14:40 INTERNATIONAL PHARMA SPONSORED SYMPOSIUM INDUSTRY SESSION Not included in main event CME/CPD credit	JAPANESE PHARMA SPONSORED SYMPOSIUM INDUSTRY SESSION Not included in main event CME/CPD credit	JAPANESE PHARMA SPONSORED SYMPOSIUM INDUSTRY SESSION Not included in main event CME/CPD credit	JAPANESE PHARMA SPONSORED SYMPOSIUM INDUSTRY SESSION Not included in main event CME/CPD credit	JAPANESE PHARMA SPONSORED SYMPOSIUM INDUSTRY SESSION Not included in main event CME/CPD credit	JAPANESE PHARMA SPONSORED SYMPOSIUM INDUSTRY SESSION Not included in main event CME/CPD credit	JAPANESE PHARMA SPONSORED SYMPOSIUM INDUSTRY SESSION Not included in main event CME/CPD credit	JAPANESE PHARMA SPONSORED SYMPOSIUM INDUSTRY SESSION Not included in main event CME/CPD credit	JAPANESE PHARMA SPONSORED SYMPOSIUM INDUSTRY SESSION Not included in main event CME/CPD credit	JAPANESE PHARMA SPONSORED SYMPOSIUM INDUSTRY SESSION Not included in main event CME/CPD credit	JAPANESE PHARMA SPONSORED SYMPOSIUM INDUSTRY SESSION Not included in main event CME/CPD credit
13:45 - 14:45				(13:00-14:30)	JAPANESE PHARMA SPONSORED SYMPOSIUM INDUSTRY SESSION Not included in main event CME/CPD credit	JAPANESE PHARMA SPONSORED SYMPOSIUM INDUSTRY SESSION Not included in main event CME/CPD credit	JAPANESE PHARMA SPONSORED SYMPOSIUM INDUSTRY SESSION Not included in main event CME/CPD credit	JAPANESE PHARMA SPONSORED SYMPOSIUM INDUSTRY SESSION Not included in main event CME/CPD credit	JAPANESE PHARMA SPONSORED SYMPOSIUM INDUSTRY SESSION Not included in main event CME/CPD credit	JAPANESE PHARMA SPONSORED SYMPOSIUM INDUSTRY SESSION Not included in main event CME/CPD credit	JAPANESE PHARMA SPONSORED SYMPOSIUM INDUSTRY SESSION Not included in main event CME/CPD credit	JAPANESE PHARMA SPONSORED SYMPOSIUM INDUSTRY SESSION Not included in main event CME/CPD credit	JAPANESE PHARMA SPONSORED SYMPOSIUM INDUSTRY SESSION Not included in main event CME/CPD credit
14:45 - 16:15	T11b: Disorders of the Autonomic Nervous System	M6b: Neuroimaging, Molecular Functional Imaging	T3b: Palliative Care	Teaching Course	Teaching Course	FREE PAPERS	Teaching Course	Teaching Course					
16:15 - 16:45	COFFEE BREAK, POSTER AND E-POSTER VIEWING AND EXHIBITION VISIT												
16:45 - 18:15	FREE PAPERS	M6c: Neuroimaging, Molecular Functional Imaging	FREE PAPERS	Teaching Course	Teaching Course	FREE PAPERS	Teaching Course	Teaching Course					
18:30 - 19:30					JAPANESE PHARMA SPONSORED SYMPOSIUM INDUSTRY SESSION Not included in main event CME/CPD credit	JAPANESE PHARMA SPONSORED SYMPOSIUM INDUSTRY SESSION Not included in main event CME/CPD credit	JAPANESE PHARMA SPONSORED SYMPOSIUM INDUSTRY SESSION Not included in main event CME/CPD credit	JAPANESE PHARMA SPONSORED SYMPOSIUM INDUSTRY SESSION Not included in main event CME/CPD credit	JAPANESE PHARMA SPONSORED SYMPOSIUM INDUSTRY SESSION Not included in main event CME/CPD credit	JAPANESE PHARMA SPONSORED SYMPOSIUM INDUSTRY SESSION Not included in main event CME/CPD credit	JAPANESE PHARMA SPONSORED SYMPOSIUM INDUSTRY SESSION Not included in main event CME/CPD credit	JAPANESE PHARMA SPONSORED SYMPOSIUM INDUSTRY SESSION Not included in main event CME/CPD credit	JAPANESE PHARMA SPONSORED SYMPOSIUM INDUSTRY SESSION Not included in main event CME/CPD credit

TUESDAY, SEPTEMBER 19, 2017

	Main Hall - Plenary	Annex Hall 1	Room A	Annex Hall 2	Room D	Room E	Room B-1	Room B-2	Room C-1	Room C-2	Room G	Room F	Room H
07:00 - 08:00						Morning Teaching Course							
8:00- 9:15	PLENARY LECTURE (Nobel lecture) 8:00-8:45												
	PLENARY LECTURE 8:45-9:15												
9:15- 10:45	M2a: Stroke	M7a: Prion Like Mecha- nisms and Neurological Disease and Novel Targets Treatment	T20a: Psy- chiatry	T4a: Au- toim- mune Disorders	T5a: Neu- roncol- ogy	Teaching Course	FREE PAPERS	Teaching Course	Teaching Course				
10:45 - 11:15	COFFEE BREAK, POSTER AND E-POSTER VIEWING AND EXHIBITION VISIT												
11:15- 12:45	M2b: Stroke	M7b: Prion Like Mecha- nisms and Neurological Disease and Novel Targets Treatment	TOURNA- MENT OF THE MINDS: HEATS QUALIFYING ROUND	T4b: Au- toim- mune Disorders	T5b: Neu- roncol- ogy	Teaching Course	FREE PAPERS	Teaching Course	Teaching Course				
12:45 - 14:45	LUNCH BREAK, POSTER AND E-POSTER VIEWING AND EX- HIBITION VISIT	13:10-14:40 INTERNATIONAL PHARMA SPONSORED SYMPOSIUM INDUSTRY SESSION Not included in main event CME/ CPD credit	13:10-14:40 INTERNATIONAL PHARMA SPONSORED SYMPOSIUM INDUSTRY SESSION Not included in main event CME/ CPD credit	JAPANESE PHARMA SPON- SORED SYMPO- SIUM INDUSTRY SESSION Not included in main event CME/CPD credit (13:00- 14:30)	JAPANESE PHARMA SPON- SORED SYMPO- SIUM INDUSTRY SESSION Not included in main event CME/CPD credit	JAPANESE PHARMA SPON- SORED SYMPO- SIUM INDUSTRY SESSION Not included in main event CME/CPD credit	JAPANESE PHARMA SPON- SORED SYMPO- SIUM INDUSTRY SESSION Not included in main event CME/CPD credit	JAPANESE PHARMA SPON- SORED SYMPO- SIUM INDUSTRY SESSION Not included in main event CME/CPD credit	LUNCH BREAK, POSTER AND E-POSTER VIEWING AND EXHIBITION VISIT				
13:45- 14:45													
16:15- 16:45	COFFEE BREAK, POSTER AND E-POSTER VIEWING AND EXHIBITION VISIT												
16:45- 18:15	M2d: Stroke	IBRO 24.1	T17a: History of Neurology	T6b: CNS Infections and Tropical Neurology	FREE PAPERS	Teaching Course	FREE PAPERS	Teaching Course	Teaching Course	Teaching Course			
18:30- 19:30					JAPANESE PHARMA SPON- SORED SYMPO- SIUM INDUSTRY SESSION Not included in main event CME/CPD credit	JAPANESE PHARMA SPON- SORED SYMPO- SIUM INDUSTRY SESSION Not included in main event CME/CPD credit	JAPANESE PHARMA SPON- SORED SYMPO- SIUM INDUSTRY SESSION Not included in main event CME/CPD credit	JAPANESE PHARMA SPON- SORED SYMPO- SIUM INDUSTRY SESSION Not included in main event CME/CPD credit	JAPANESE PHARMA SPON- SORED SYMPO- SIUM INDUSTRY SESSION Not included in main event CME/CPD credit	JAPANESE PHARMA SPON- SORED SYMPO- SIUM INDUSTRY SESSION Not included in main event CME/CPD credit	JAPA- NESE PHARMA SPON- SORED SYMPO- SIUM INDUS- TRY SES- SION Not in- cluded in main event CME/CPD credit	JAPA- NESE PHARMA SPON- SORED SYMPO- SIUM INDUS- TRY SES- SION Not in- cluded in main event CME/CPD credit	JAPA- NESE PHARMA SPON- SORED SYMPO- SIUM INDUS- TRY SES- SION Not in- cluded in main event CME/CPD credit

THURSDAY, SEPTEMBER 21, 2017

	Main Hall - Plenary	Annex Hall 1	Room A	Annex Hall 2	Room D	Room E	Room B-1	Room B-2
08:00 - 09:00	PLENARY LECTURE 8:00-8:30							
	PLENARY LECTURE 8:30-9:00							
09:00 - 10:30	T18a: The Role of Microglia In Neurological Disease	T12a: Neurocritical Care	FREE PAPERS	REGIONAL SYMPOSIUM 6	Teaching Course	FREE PAPERS	FREE PAPERS	FREE PAPERS
10:30 - 11:00	COFFEE BREAK OUTSIDE SESSION HALLS							
11:00 - 12:30		T12b: Neurocritical Care	T19a: Big Data and Personalized Medicine	Neurosurgery 21.1	Teaching Course	FREE PAPERS	FREE PAPERS	FREE PAPERS
12:30 - 12:45	SHORT BREAK							
12:45 - 14:00	TOURNAMENT OF THE MINDS: FINAL							
14:00 - 14:30	CLOSING CEREMONY							

SUPPORT LEVELS AND BENEFITS

Supporters will be given a support category status dependent upon the total amount of your support. The total contribution will consist of items such as industry sessions, advertisements, and exhibition space. You will benefit from outstanding advantages linked to your support category.

Status will be allocated as follows:

Category	Amount
Platinum Support	
Gold Support	
Silver Support	
Bronze Support	

Benefits according to the following levels:

Benefit	Platinum	Gold	Silver	Bronze
Final list of participants (after the Congress) includes only participants who agreed to share their information	✓	✓	–	–
Supporter's Logo (Company logo only, no product logo) with hyperlink on Congress website	✓	✓	✓	✓
Supporter's logo (Company logo only, no product logos) in the Final Program	✓	✓	✓	✓
Complimentary Congress registrations	15	10	7	4
Promotional Email Blast	✓	–	–	–
Extra Exhibition Badges	10	5	3	2
Acknowledgement on Supporters' board on-site	✓	✓	✓	✓

Branded items will carry company logos only. No products logos or advertisements are permitted.

*Advertisements in the Congress Program will be included in the Industry Support and Exhibition section.

All supporters will be acknowledged in the Industry Support and Exhibition section of the program, on the event website, and with signage during the event.

Special Requests

Tailored packages can be arranged to suit your objectives. Please feel free to contact the Industry Support and Exhibition Sales Department to discuss your needs (Contact information provided in the "General Information" section).

Educational Support Opportunities

EDUCATIONAL GRANT

Grants of any amount, whether for the overall programme or for individual sessions, are appreciated and important to the success of the event.

- ▶ Support will be acknowledged in the Industry Support and Exhibition section of the Final Programme, on the event website, and with signage during the event.



EDUCATIONAL GRANT IN SUPPORT OF EXISTING SCIENTIFIC SESSION

Educational Grant in support of an Existing Official Session accepted or invited by the Conference Planning Group and supported by a grant from the industry.

- ▶ Support will be acknowledged in the Industry Support and Exhibition section of the Final Programme, on the event website, and with signage during the event.



POSTER BOARDS

- ▶ Support will be recognised with signage at the entrance to the Poster area with "Supported by..." and a company logo
- ▶ Support will be acknowledged in the Industry Support and Exhibition section of the Final Programme, on the event website, and with signage during the event



WEBCASTING

The ability to attend all conferences, or alternatively, all conference sessions, is virtually impossible for the busy medical professional. Therefore there is a growing need to share knowledge and learning opportunities beyond the dates of the actual event and high-quality webcasting helps meet this substantial educational need. Materials are saved locally, but at the same time, can be distributed over the web to viewers around the world via a robust cloud server. Viewers can access the broadcasts using PCs, tablets or smartphones live (as streamed video) or later, on-demand as a webcast.



Kenes offers two types of webcasting options*:

- ▶ **Video** includes a video screen of the speaker/presenter during the session, PowerPoint slides (in sync with the speaker), and audio
- ▶ **Digital Imaging** includes PowerPoint slides with audio
- ▶ Support will be recognized on the home screen with "Supported by..." and a company logo only
- ▶ Support will be acknowledged in the Industry Support and Exhibition section of the programme, on the event website, and with signage during the event

*Webcasted sessions to be designated by the Conference Planning Group. Supporter will have no influence on content.

MOBILE APPLICATION

The Conference App engages attendees with personalized planning tools and real-time event updates. The App transforms smartphones, tablets and laptops into a tool for active meeting participation, making it easy for participants to access meeting information they need and to connect with speakers and colleagues. The App includes the scientific programme, abstracts, speaker info, participant lists, rating/voting system for sessions/speakers and a personalized scheduler and is easily downloadable from the App Store and Google Play.



Illustration only

Conference App support includes:

- ▶ Supporter acknowledgement on the splash/pop-up screen of the app: "Supported by: company name/logo" (product logo not permitted)
- ▶ Signage on site with App QR code and "Supported by: company name/logo" (product logo not permitted)
- ▶ 2 "push notifications" are included in the sponsorship package
- ▶ Priority listing in the list of conference exhibitors
- ▶ Support will be acknowledged in the Industry Support and Exhibition section of the Final Programme, on the event website, and on signage during the event

Please note that it is the Exhibitor's / Supporter's responsibility to comply with the local authority's regulations, EFPIA (European Federation of Pharmaceuticals Industries & Associations) www.efpia.org and IFPMA (International Federation of Pharmaceutical Manufacturers & Associations) www.ifpma.org Code of Practice on the Promotion of Medicines.



Promotional Support Opportunities

SATELLITE SYMPOSIUM

Opportunity to organize an Official Satellite Symposium in a parallel hall, up to 90 minutes (Program subject to the approval by the WCN 2017 scientific committee).

- ▶ Includes: hall rental, standard audio/visual equipment, display table
- ▶ Permission to use the phrase: "Official Satellite Symposium of the WCN 2017"
- ▶ Symposia Programs will be included in the Industry Support and Exhibition section of the Program (subject to receipt by publishing deadline)
- ▶ Indicated in the program as: Satellite Symposium (not included in the main event CME/CPD credit offering)

PARALLEL SYMPOSIUM



Illustration only

WELCOME RECEPTION / NETWORKING EVENT

Supporter will have the opportunity to promote itself through the welcome reception / networking reception to which all registered attendees are invited. Hospitality and any activities provided will be in compliance with all relevant industry codes

- ▶ Supporter's logo on sign at the entrance to the reception
- ▶ Opportunity to provide items bearing company logo for use at the event
- ▶ Support will be acknowledged in the Industry Support and Exhibition section of the Final Programme, on the event website, and with signage during the event

CONGRESS LANYARDS

Opportunity to place company logo on the lanyards. The Conference Planning Group will select the type and design of the lanyards. The support entitlements are as follows:

- ▶ Supporter's logo to be printed on the lanyards
- ▶ Supporter's logo on Conference website
- ▶ Support will be acknowledged in the Industry Support and Exhibition section of the Final Programme
- ▶ Acknowledgement on Supporters' board on-site



CONGRESS BAGS

Supporter will provide funding of the Conference bags.

- ▶ The bag will bear the Supporter's logo and the Conference logo
- ▶ Acknowledgement on Supporters' Board on-site
- ▶ Acknowledgement in the Supporters' List in the Final Program
- ▶ The bag must be approved by the organizing committee in advance.



NOTEPADS AND PENS

Supporter's logo placed on every pen and notepad. Notepads and pens will be inserted to the congress delegates' bags.

PROMOTIONAL MATERIAL (BAG INSERT)

One page company brochure that will be included in the delegates' bags.

Please note that all material entering the venue incur a handling charge. This includes material for inserts and display. In order to receive a price quote for handling and to assure arrival of your material, please be sure to complete the "Pre-Advise" form included in the shipping instructions when you receive either the Exhibition or Symposia Technical Manuals.

ADVERTISEMENT OPPORTUNITIES

MINI PROGRAMME

FINAL PROGRAMME - INSIDE PAGE / INSIDE BACK

Full inside page color advertisement in designated section of the Final Programme.

The Final Programme will contain the timetable, information about the scientific programme and other useful information. It will be distributed to all registered participants in the Conference bags.

PROMOTIONAL MAILBLAST - EXCLUSIVE OR JOINT

Gain additional exposure for your Symposium, company or exhibition booth by sending out a Mail Blast to the preregistered delegates who have agreed to disclose their details at a date and time coordinated with the Conference Organizer.

- ▶ **Exclusive:** Mail blast will be exclusive for the supporting company. The designed mail blast (html) to be provided by the Supporter and subject to receipt by deadline.
- ▶ **Joint:** Mail blast will list all supporting companies according to the support level. Each company will have a section of approximately 150 words. Design will be provided by Organiser.

Support will be acknowledged in the Industry Support and Exhibition section of the Final Programme, on the event website, and with signage during the event.



PUSH NOTIFICATION

A promotional message will be integrated into the mobile application with a note from the supporting company. Supporter will be able to promote his integrated symposium/booth/product via the promotional messages.



EXHIBITION OPPORTUNITIES

Space Only Rental

This includes:

- ▶ Exhibitors badges
- ▶ 100 Word Company / product profile in the Industry Support and Exhibition section of the program
- ▶ Cleaning of public areas and gangways
- ▶ Invitation to the Welcome Reception for registered exhibitors

Shell Scheme Rental

This includes:

- ▶ Exhibitors badges
- ▶ Shell scheme frame, basic lighting
- ▶ Fascia panel with standard lettering
- ▶ 100 Word Company / product profile in the Industry Support and Exhibition section of the program
- ▶ Cleaning of public areas and gangways
- ▶ Invitation to the Welcome Reception for registered exhibitors

Shell Scheme stand sketch
Illustration only

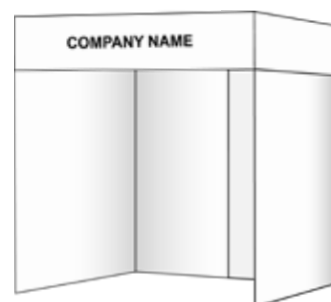

****Please note:** Space only/shell scheme rental does not include any furniture, electrical usage or stand cleaning. All these services and others will be available to order in the Exhibitors Technical Manual.



EXHIBITION FLOOR PLAN (Subject to change)

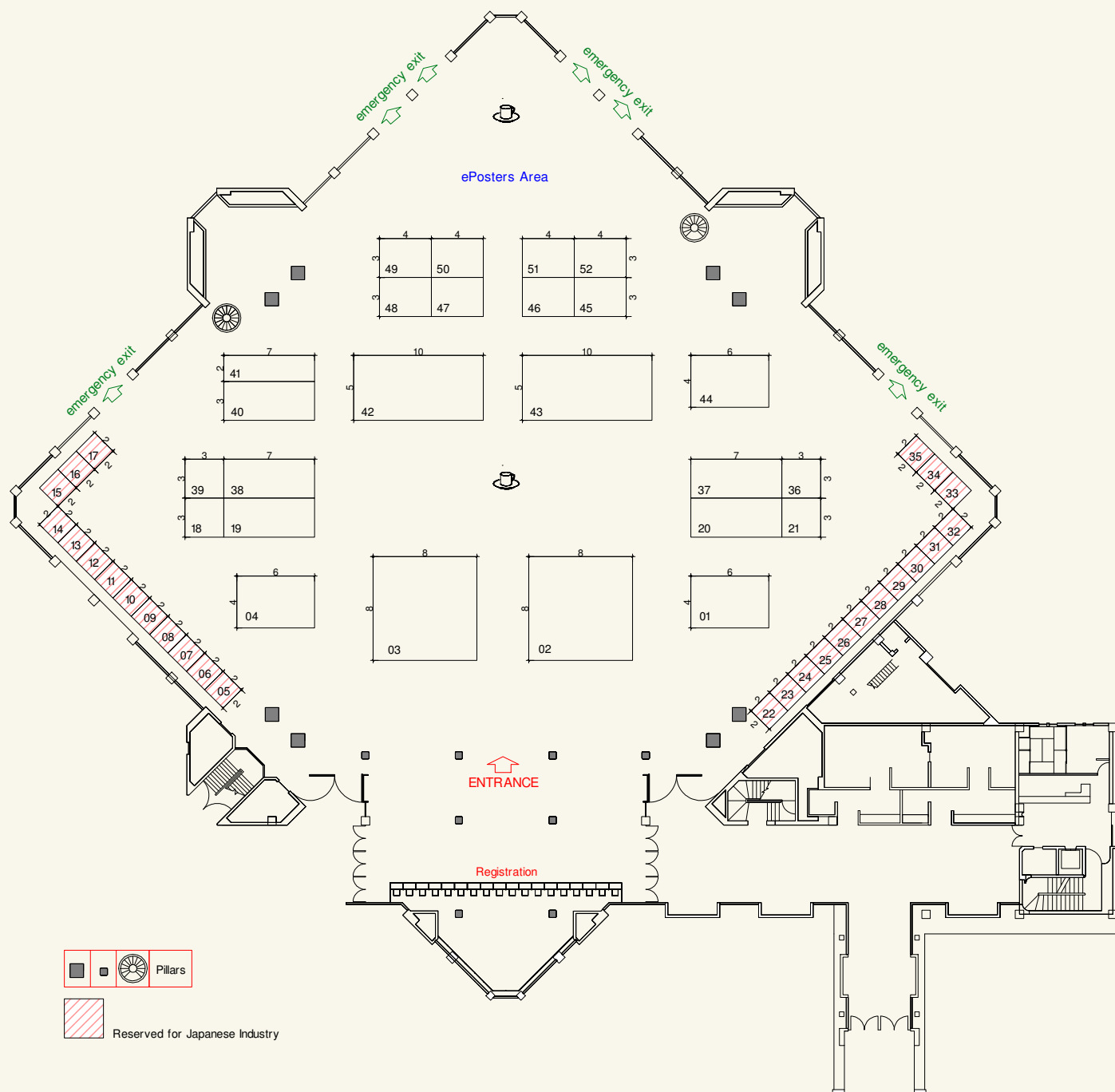

GENERAL INFORMATION AND CONDITIONS OF EXHIBITION:

Allocation of Exhibition Space

Space Allocation will be made on a “first come, first served” basis. A completed Exhibition Booking Form and Contract should be faxed / emailed to ensure reservation of a desired location. Upon receipt of the Exhibition Booking Form and Contract, space will be confirmed and an invoice will be mailed. Please note that three alternative choices should be clearly indicated on the application form. Space allocations will be made in the order in which application forms with payment are received.

Exhibitor Registration

All exhibitors are required to be registered and will receive a badge displaying the exhibiting company name.

Three exhibitor badges will be given for the first 9 SQM booked and two additional badges for each 9 SQM extra. Any additional exhibitors will be charged an exhibitor registration fee of US\$150 USD. Companies can purchase a maximum number of exhibitor registrations as follows: Exhibitor registrations allow access to the exhibition area only and shall be used by company staff only. An exhibitor registration form will be included in the Exhibitors Manual.

Exhibitors' Technical Manual

An Exhibitors Technical Manual outlining all technical aspects of exhibiting will be circulated 2 months prior to the WCN 2017 Congress. It will include the following:

- Technical details about the Venue
- Final exhibition details and information
- Contractor details
- Services available to exhibitors and order forms

Exhibitor Profile

Upon receipt of the booking form, you will be asked to please upload a 100-word Exhibitor Company/Product profile to a provided link. This will be published in the list of exhibitors in the Industry Support and Exhibition section of the Program.

Exhibition Terms & Conditions

The Terms and Conditions of exhibiting are included in this Prospectus. Please note that signing of the BOOKING FORM AND CONTRACT indicates acceptance of these Terms and Conditions. The Exhibition Booking Form will be held as a valid liable contract, by which both parties will be bound.

Further details will be included in the Exhibition Technical Manual.

BOOKING FORM AND CONTRACT

Please complete all details and send to:

Judit Gondor

XXIII World Congress of Neurology 2017

Kenes International

Rue François-Versonnex 7, CH-1207 Geneva, Switzerland

Tel: +41 22 908 0488 Ext. 531, Fax: +41 22 906 9140, E-mail: jgondor@kenes.com

CONTACT NAME: _____

COMPANY NAME: _____

ADDRESS: _____ ZIP CODE: _____

CITY: _____ COUNTRY: _____

TELEPHONE: _____ FAX: _____

EMAIL: _____

WEBSITE: _____ VAT NO.: _____

I would like to reserve the following Support items:

Items	Price	Please tick ✓
Educational Support Opportunities		
Educational Grant	Indicate amount:	
Educational Grant In Support of Existing Scientific Session		
Poster Boards		
Webcasting		
Mobile Application		
Promotional Support Opportunities		
Satellite Symposium (Parallel)		
Welcome Reception / Networking Event		
Congress Lanyards		
Congress Bags		
Notepads and Pens		
Promotional Material (Bag Insert)		
Mini Program		
Final Program Advertisement – Inside Page/ Inside Back		
Promotional Mail blast – Exclusive/Joint		
Push Notification		
Total Amount (please complete)		

I would like to reserve the following Exhibition Space:

Choice	Stand No.	Space Only / Shell Scheme	No. of sqm	Total Price
Choice #1				
Choice #2				
Choice #3				
Total Amount (please complete)				

Special Notes: Please indicate if your stand must be located adjacent to or opposite the following companies _____

Status will be allocated according to the total amount of your support, as follows:

Category	Amount
Platinum Support	
Gold Support	
Silver Support	
Bronze Support	

Company contact for Accommodation:

Email: _____ Telephone number: _____

Mobile number: _____

Company contact for Group Registration:

Email: _____ Telephone number: _____

Mobile number: _____

Company contact for Finance (Invoicing):

Email: _____ Telephone number: _____

Mobile number: _____

Provisional Booking – The item will be released if not confirmed within 14 days

Please send me a contract and first deposit invoice

Terms of Payment

60% upon receipt of agreement and first invoice
40% by June 15, 2017

All payments must be received before the start date of the WCN 2017. Should the Supporter fail to complete payments prior to the commencement of the WCN 2017, the Organizer will be entitled to cancel the reservation while cancellation will be subject to cancellation fees as determined below.

Cancellation/Modification Policy

Cancellation or modification of support items must be made in writing to the Support & Exhibition Sales Department:

[Judit Gondor at: jgondor@kenes.com](mailto:jgondor@kenes.com).

The organizers shall retain:

- ▶ 10% of the agreed package amount if the cancellation / modification is made on or before December 16, 2016 inclusive.
- ▶ 50% of the agreed package amount if the cancellation / modification is made between December 17, 2016 and May 15, 2017 inclusive.
- ▶ 100% of the agreed package amount if the cancellation / modification is made from May 16, 2017 onwards.

Payment Methods

Option 1: Payment by check in US\$

Please make check payable to: WCN 2017, Japan

Option 2: Payment by Bank Transfer in US\$

Please make drafts payable to: WCN 2017

Bank Account: WCN 2017 congress, Japan

Account Number: 693980-52-802

Currency: USD

IBAN: CH49 0483 5069 3980 5280 2

Clearing Number: 4835

SWIFT/BIC code: CRESCHZZ12A

Bank charges are the responsibility of the payer.

Signature: _____ Date: _____

We accept the contract terms and conditions (listed in this Support Prospectus) and agree to abide by the Guidelines for Industry Participation for the meeting. I am authorized to sign this form on behalf of the applicant/company.

TERMS AND CONDITIONS

These terms and conditions are the contractual agreement between Kenes International (the "Organizer") and the "Exhibitor".

Application to Participate

Application to participate as Exhibitor in the Congress will be considered only if submitted to Kenes on the appropriate forms, duly completed. Registration will be confirmed insofar as space is available. Applicants will be informed in writing of the acceptance or refusal of their application. In case of refusal, all payments shall be fully refunded. In case of acceptance Exhibitor will be bound by the terms and conditions listed herein and/or in the prospectus and/or any other contractual agreement between the parties.

Obligations and Rights of the Exhibitor

Registration implies full acceptance by the Exhibitors of the exhibition regulations. Any infringement of these regulations may lead to immediate withdrawal of the right to participate in the congress without compensation or refund of sums already paid, and without prejudice to the Exhibitor.

By submitting an application to participate, the Exhibitor makes a final and irrevocable commitment to occupy the space allocated and to maintain his/her/it installation until the date and time fixed for closure of the event.

The Exhibitor may only present on his/her/it stand or space the materials, products or services described in the application to participate. No advertising on behalf of firms not exhibiting is permitted in any form whatsoever. Transfer or sub-letting of all or part of the allocated spaces is prohibited.

Obligation and Rights of Organizer

The Organizer undertakes to allocate to the Exhibitor a space on the basis of the preference expressed by applicants. Application will be considered in order of receipt of application forms accompanied by payment. The Organizer reserves the right, in case of absolute necessity, to modify the positioning of stands, with no obligation to provide compensation to Exhibitors. The Organizer reserves the right to offer to a different firm any stand space that has not been occupied by the time of the opening of the congress, with no obligation to provide compensation to the defaulting Exhibitor.

Liability/Insurance

Equipment and all related display materials installed by Exhibitor are not insured by the Organizer, and the Organizer under no circumstances will be liable for any loss, damage or destruction caused to equipment, goods or property belonging to Exhibitor. The Exhibitor agrees to be responsible for his/her/its property and person and for the property and persons of his employees and agents and for any other third party who may visit his/her/its space. The Exhibitor sRoom Hold harmless and indemnify the Organizer, its shareholders, directors, employees, agents and representatives, from any and all damages, loss, injuries, costs, penalties and claims, including those claims and damages usually covered by a fire and extended under a coverage policy, sustained or incurred by the Exhibitor and/or their affiliates and/or representatives in connection with the Exhibitor's materials, equipment, goods or property used or displayed in the event. The Exhibitor will purchase insurance policies for the above listed damages.

Organizer reserves the right to change the venue, time and date of any Congress activities without being liable to Exhibitor for any damages or loss resulting therefrom. Exhibitor will be notified in writing as soon as a change is made.

Exhibition Regulations

The exhibition manager (the "Exhibition Manager"), acting under direction of the organizing committee, has the final decision as to the acceptability of displays. Exhibitors are not allowed to share with others any space allotted to them without prior written consent by the Exhibition Manager.

The Organizer reserves the right to alter the general layout or limit the space allotted to each Exhibitor, postpone the exhibition or transfer it to another site if unforeseen circumstances warrant such action. Should any contingency prevent the holding of the exhibition, the Organizer will not be held liable for any expenses incurred other than the cost of exhibit space rental fees.

All exhibits are to be displayed so as to avoid blocking aisles, obstructing adjoining booths, damaging the premises or the leased equipment. The Exhibitor is kindly requested to allow sufficient see-through areas, which ensure clear views of surrounding exhibits.

In standard booths, height is restricted to 246cm. Exhibitors are responsible for the cost and execution of the design, installation and delivery of their display to (and its removal from) the exhibition site.

Flammable materials are not allowed to be utilized. Equipment displayed or demonstrated must be installed with strict adherence to safety measures.

The Exhibitors undertake to observe the timetable designated for completion of their display before the exhibition opening and its dismantling at the close of the exhibition. No dismantling or packing of the display before the designated hour is allowed. It is the Exhibitor's responsibility to pack and remove or consign for shipment all items of value prior to leaving their exhibit unattended, otherwise the Organizer will arrange for their removal at the Exhibitor's risk and sole expenses. Exhibitors are obliged to ensure that their stands are permanently staffed during the exhibition opening hours.

Payment is to be made in accordance with the conditions of payment listed in the prospectus or as shall be agreed in writing with the Organizer. Should the Exhibitor fail to make such payment on time, the Organizer shall be entitled to terminate the contract, withdraw confirmation of acceptance, make other arrangements for the space or seek compensation for non-fulfilment of contract. Participation by Exhibitor is dependent upon compliance with all rules, regulations and conditions stated herein.

Access to the exhibition is authorized on presentation of a badge issued by the Organizer. Exhibitor's badges will not be mailed in advance and may be collected from the Exhibition Manager's desk on the exhibition commencement date.

The Organizer ensures daily cleaning of the aisles. Exhibitors are responsible for the cleaning of their stands.

The provision of refreshments for the participants by Exhibitor is only permitted if the catering regulations of the exhibition building concerned are observed.

Organizer is not liable or responsible for the quality and/or quantity of the Exhibitor's refreshments. The Exhibitor sRoom Fully indemnify, defend and hold harmless the Organizer, its shareholders, directors, employees, agents and representatives, from and against any and all liability, losses, claims, actions, proceedings, injuries, demands, fees, penalties, judgments, fines, damages, costs and/or expenses (including reasonable attorneys' fees and costs) sustained or incurred by any third party in connection with the use or consumption of the Exhibitor's refreshments.

All demonstrations or instructional activities must be confined to the limits of the exhibition stand, with prior consent from the Organizer. Advertising material and signs may not be distributed or displayed outside the exhibitor's stands. Advertising panels and display are not permitted outside the exhibition areas allotted to the Exhibitors. Sound equipment must be regulated and directed into the stand so that it does not disturb neighbouring exhibits. The exhibition management reserves the right to require the Exhibitor to discontinue any activity, noise or music that is deemed objectionable.

Exhibition areas and fittings made available to Exhibitor must be handed back in their original condition. In case of damage or loss of equipment provided, or damage to areas occupied, repair and replacement will be charged to the Exhibitor. Any special decoration or fittings must be submitted to the Organizer for prior authorization.

The Organizer will not approve stands, which do not comply with the accepted standards, until the necessary changes have been made.

Industry Code of Practice

It is the Exhibitor's responsibility to comply with the local authority's regulations, EFPIA (European Federation of Pharmaceuticals Industries & Associations) www.efpia.org, Eucomed (represents Medical Technology industry) <http://archive.eucomed.org/> and IFPMA (International Federation of Pharmaceutical Manufacturers & Associations) www.ifpma.org code of practice on the promotion of medicines. Failure to comply with these regulations may not be used as a ground to declare the contract void. Failure to comply with the rules and regulations will not expose the Organizer to any suits, demands by the Exhibitor or any other third party.

CME

Absolutely no promotional activities will be permitted in the same room immediately prior to, during, or after a CME activity. Exhibit materials must be in a room or area separate from the education and the exhibits must not interfere, or in any way, compete with the learning experience. All promotional activities including interviews, demonstrations, and the distribution of literature or samples must be made within the Exhibitor's space only; canvassing or distributing promotional materials outside the Exhibitor's rented exhibit space is not permitted.